

Tech Specification

Product Name: Kensington Curved Vanity Unit

Product Code: CURVEDBASINUNIT4026

A lacquered top coat with 5 layers of primer featuring UV stabilization to minimise colour fading from exposure to sunlight.

Drawers are soft closing

Chrome plated metal handles

Fully assembled

One adjustable glass shelf

The plinths of the freestanding furniture are crafted from HDP Polymer a waterproof base
Minerva worktops are supplied with an integrated bowl with overflow, and no tap holes. Tap holes are drilled by the installer in the required position and configuration. A template is provided with the Minerva tops indicating tap hole positions and sizes.

A backsplash is supplied with the worktop but is optional as to whether you want to use it. This can be fit into place using silicon.

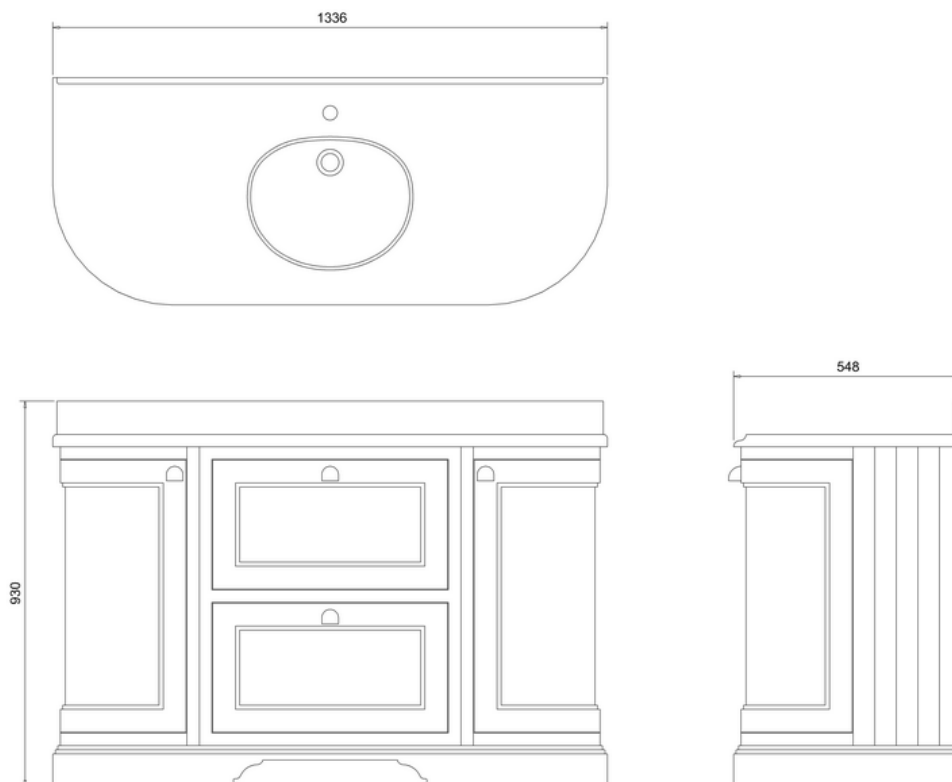
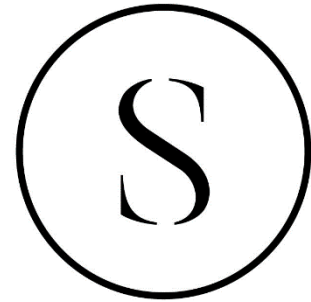

Tech Specification

Product Name: Kensington 3 Tap Hole Set

Product Code: 3THTAPS4034

Includes Pop-Up Waste

Guarantee*

10 years domestic installations

1 year commercial installations

